



DIVISION 2 STATE SKI FINALS FACT SHEET

Boyne Highlands Ski Resort (855) 688-7022 – February 24th 2025

- Host** Clare High School & Orchard Lake St. Mary's
- Lift Tickets** 3-Day (Saturday–Monday) - \$99, 1-Day (Saturday or Sunday) - \$55, 1-Day (Monday for race) - \$10. Each team will receive 2 complimentary coach tickets. **Every racer & coach must complete the Racer and Waiver form below.** Highlands will provide coaches with a specific roster form to complete. Once submitted, Highlands will issue an order number and total price. A team representative then calls **231.526.3030 (Option 9)** with the order number to make payment. Payments can be made on Monday morning, but pre-payment is recommended to avoid delays. Tickets can be picked up on Monday at 7:00 AM at the Snowsports Desk unless other arrangements have been made. Contact: **Anna Binoir** at anna.binoir@boynehighlands.com.
- Waivers** A Racer Info Form & Signed Waiver by parent/guardian for each participant and support team member on the team roster must be provided to receive lift tickets. Link to Competition Waiver: <https://forms.office.com/r/CLKzECZJ3J>
- Team Areas** Day Lodge
- Breakfast** A breakfast Buffet is available in the main dining room starting at 7:00 am.
- Lodging** Boyne Highlands Reservations: (888)-436-2296, web link - <https://www.highlandsharborssprings.com/lodging/book-lodging?Group=14F0ED&checkin=02%2F21%2F25&Checkout=02%2F24%2F25#/room>
Group Sales Validation Code: 14F0ED
- Numerous places in Harbor Springs and Petoskey.
Visit <https://petoskeyarea.com> (Lodging & Dining) or
The Petoskey Area Visitors Bureau at 231-345-2755.
- Waxing** Wax room 1 – Locker room – Available Sun 7:00am to 11:00pm
Wax room 2 – Tailgate room - Available Sun 7:00am to 11:00pm (reference map for locations)
- Venue Prep** We will need help with b-net set up on Sunday afternoon beginning around 1:30pm
- Course Details** Morning: Men Giant Slalom North Challenger, 1st run skiers right
Women Slalom South Challenger, 1st run skiers right
- Afternoon: Men Slalom South Challenger, 1st run skiers right
Women Giant Slalom North Challenger, 1st run skiers right
- Course Setting** Sunday Course Setting & Jury Inspection at 6:30 pm, Sunday February 23, 2025, Contact Tim Gariglio to participate (989)205-0144 or timgariglio@gmail.com



Coaching Meeting 7:30am Tailgate Room (Day lodge)

Workers 7:45am Gatekeeper meeting Camelot Room (Day Lodge)

MORNING SESSION:

Order of Race:

7:45am	Express & Challenger Lifts open. <i>No warm-up in racing area</i>
8:15-8:40am	Inspection
8:45am	National Anthem (GS Course)
8:50am	Forerunners
9:00am	First run begins: Men's GS, Women's SL (both skiers right)

Inspection for run #2 opens 10 minutes after completion of 1st run

- Inspection closes 20 minutes after opening
- Forerunners for run #2 skiers left.

****DQ's will be posted after each flight is completed on the finish leader board until 15 minutes after the completion of each run. Protests must be made within 15 minutes after the completion of each run.**

AFTERNOON SESSION:

- Course inspection begins approximately 60 minutes after completion of morning session, open for 20 mins, then afternoon session begins, 2nd event begins approximately 90 minutes after completion of 1st event

Course Tear-Down & B-Netting Removal: ALL TEAMS MUST PARTICIPATE

Coaches Meeting Approximately 1 hour after the completion of the last racer in Tail Gate Room

Awards Immediately after the Coaches Meeting in Blue Room (Banquet Area in Day Lodge)

Run orders Email to Amy McLeod at candamcleod@gmail.com and copy to timgariglio@gmail.com (Due Friday 2/17 @ 4pm. Please include coach's phone number).

Volunteer Per MHSAA rules, all qualifying teams must provide two volunteers for each gender for both morning and afternoon events. Failure to do so may subject the team to an additional 5 points added to the team's score. Please use the attachment for your volunteers' names, and their preference men's or women's course and their phone number if possible and return to timgariglio@gmail.com

Food Food commercial and non-commercial can be brought into The Highlands buildings. Due to health code regulations, **no food being brought in can be plugged in.** The Highlands is respectfully receptive to teams hosting their own lunches, however, any food that requires to be warmed up cannot be done so at the lodge. **No Crock pots, hot plates, or open flame heating.** Out of respect for The Highlands food service please adhere to this request and make sure your areas are cleaned up.



2025 DIVISION 2 STATE SKI FINALS RACE DAY SCHEDULE OF EVENTS

7:00 AM Lodge Opens, registration & purchase lift tickets, pre-ordered pick up at Snowsports desk.
7:30am Scratch Deadline/Substitution Deadline for first event (Day Lodge)
7:30am Coaches Meeting in Tailgate Room
7:45am Express & Challenger Lifts open
7:45am Worker/Gatekeeper meeting in Camelot Room (Day Lodge)
Lift Opens, no warm up in race areas

Morning Event

8:15 – 8:40am Inspection of run 1 skier right
8:45am National Anthem
8:50am Forerunners
9:00am First runs begin: Boys Giant Slalom & Girls Slalom (both skiers right)
Run 2 Inspection for run 2 will be begin 10 minutes after last racer. Inspection will be open for 20 minutes

Reset Courses Jury Inspection

Afternoon Event *Scratch Deadline in Finish Shack 30 minutes after finishing morning session*

Course inspection begins approximately 60 minutes after completion of morning session, open for 20 mins, then afternoon session begins, Inspection of run 1 skier right (Men's Slalom, Women's GS)

Start Time Begins approximately 90 minutes after completion of 1st event

Same timeline as morning for skier's 2nd event. (run 1 skiers right)

****DQ's will be posted after each flight is completed on the finish leader board until 15 minutes after the completion of each run. Protests must be made within 15 minutes after the completion of each run.**

Coaches Meeting Approximately 1 hour after last racer. Review results and sign off in (Tailgate Room)

Awards Immediately following the coach's meeting in Blue Room (Day Lodge)



Boyne Highlands Map & Training Schedule



Saturday, February 22 nd	9:00 – 11:00am	11:00 – 1:00pm	1:00pm – 3:00pm
North Tournament Skiers Rt. (Slalom)	Region 4	Region 6	Region 5
South Tournament Skiers Lt. (Slalom)	Region 5	Region 4	Region 6
North Tournament Skiers Lt. (GS)	Region 6	Region 5	Region 4
Sunday, February 23 rd	9:00 – 11:00am	11:00 – 1:00pm	1:00pm – 3:00pm
South Challenger Skiers Rt. (Slalom)	Region 6	Region 5	Region 4
South Challenger Skiers Lt. (Slalom)	Region 5	Region 4	Region 6
North Challenger Skiers Rt. (GS)	Region 4	Region 6	Region 5



2025 D1 State Ski Finals

Boyer Highlands Lodge Maps and Wax Room Locations

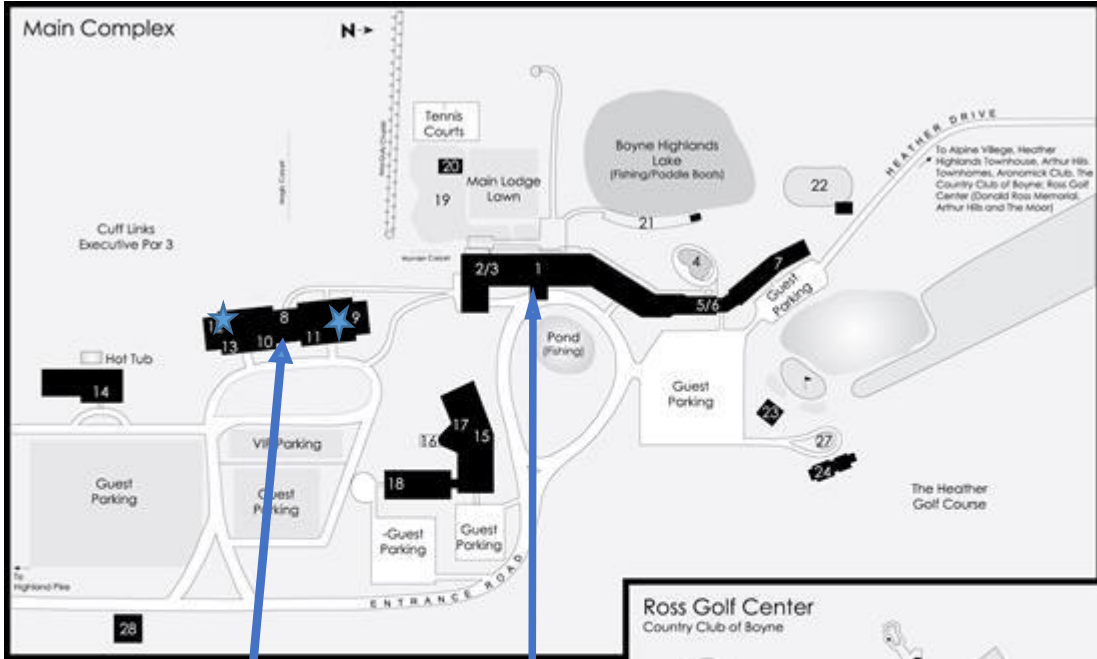

Day Lodge
Waxing Room 1 | Tailgate
Waxing Room 2 | Locker Rooms
 (lower level under Zoo Bar)

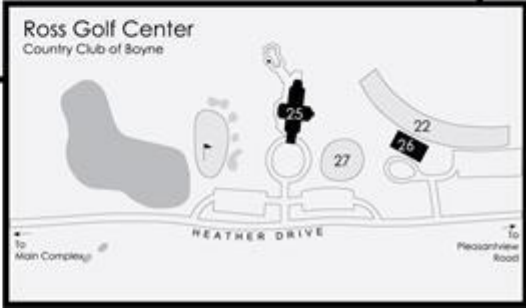

Main Lodge | Hotel Check in

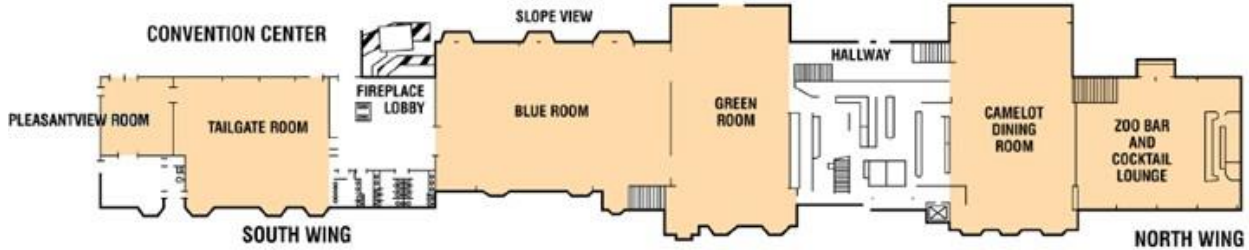

Waxing Space
 Upper Level | Tailgate Room
 Lower Level | Locker Rooms (under Zoo Bar and Cocktail Lounge)

